



GENERAL INFORMATION

SERIES 4204 LABORATORY ROTARY DIVIDER

SN: Pending

Gamet Manufacturing Incorporated
698 Prior Avenue North
Saint Paul Minnesota 55104
651-647-5410, Fax 651-647-5412
E-mail: info@gametmfg.com

ABOUT THIS MANUAL

Gamet Manufacturing Inc. is pleased to provide to you this comprehensive manual covering the installation and operation of your **Laboratory Rotary Divider**. This manual will cover all aspects of system use including, but not limited to:

- Unpacking
- Warranty
- System Operation
- Required Tools
- Installation
- System Maintenance
- System Trouble Shooting

Should you have any questions regarding this or any of our products please contact our customer service department at 888-647-5475.

TABLE OF CONTENTS

Introduction	1
Safety Precautions	2
Description and Operation	3
Required tools for installation / Unpacking Instructions	4
Installation	5
Exploded View	6
Parts List	7
Replacement Parts	8
Cleaning and Maintenance	9
Trouble Shooting	10

INTRODUCTION

This manual is written as an aid for our customer and the contractors who install and use our equipment. Gamet provides the finest quality electro-mechanical sampling, weighing and testing equipment.

Gamet is recognized throughout the agricultural community for its fine quality and durable product line. All Gamet products are supplied with electric controls, designed and fabricated to meet all National Electric Codes (NEC) standards. All electric drive components are suitable for the environment that the equipment will be used in.

A manufacturer of equipment since 1937, Gamet prides itself on quality and customer service. We invite you to enjoy the use of your Laboratory Rotary Divider. Should you feel that our system is not everything we advertised please contact our customer service department. We will correct or replace the unit until you are satisfied.

WARRANTY

Gamet warrants this product to be free of defect due to manufacturer error for a period of one (1) year from the date of purchase. Gamet will replace all defective components with a suitable replacement, freight pre-paid. Installation and physical replacement of the warranty items is the customers' responsibility.

SAFETY PRECAUTIONS

All Gamet products are supplied with suitable danger warnings / stickers. Please be sure to keep all such warnings visible to users at all times.

During installation of our equipment be certain electric power is not connected to the device. The risk of electric shock is ever present during typical installation projects. Respect and use the Occupational Safety and Health Administration (OSHA) lock-out / tag-out rules when using or installing any Gamet products.

Most Gamet products are supplied with parts that can move under normal use. We take care to place guards over moving parts to protect users. Do not attempt to operate machinery with any of the safety devices removed.

Gamet products are fabricated of high quality, durable materials. Thus most Gamet products are very heavy and require special lifting equipment to assemble or mount in place. Be sure to use the lifting lugs or surfaces provided as part of the equipment when installing equipment.

DESCRIPTION AND OPERATION

The Gamet “Laboratory Rotary Divider” is a device designed to reduce a sample obtained by other means to a useable size in a representative manner. This is accomplished as follows:

- 1) Place sample in hopper at the front of the machine. (Be certain to close the inlet gate before loading hopper)
- 2) Place plastic collection bins under the sample discharge spouts.
- 3) Turn on the divider by using the switch at the right of the motor mount.
- 4) Open the inlet gate allowing product to fall into the divider.
- 5) When all sample has passed through the divider (sound of grain will be gone) turn off the divider.
- 6) Close inlet gate.
- 7) Process samples per testing guidelines and regulations.

REQUIRED TOOLS FOR INSTALLATION

- Level
- ½” open end wrench

UNPACKING REQUIREMENTS

- Lab Divider, Main Assembly (1)
- Plastic collection bins (4)
- Users manual (1)

Should any of the above items be missing upon receipt of the product please contact our customer service department.

INSTALLATION

- 1) Locate appropriate counter top location for the divider (be certain a 110V electric socket is located close so the unit can be plugged in).
- 2) Place divider on the counter top on its back. Remove the wood shipping base using the wrench.
- 3) Locate the mounting feet (4) that are attached to the motor. Mount the feet in the four threaded base holes. Do not tighten until done with step 4.
- 4) Level the device by placing up right, then placing a level on the main base check to see if the device is level. If not, thread the feet in or out of the holes on the bottom of the base until it is. Use the 1/2" wrench to tighten the lock nut on the feet to the base.
- 5) Unwrap and plug the power cord into the 100V electric socket.

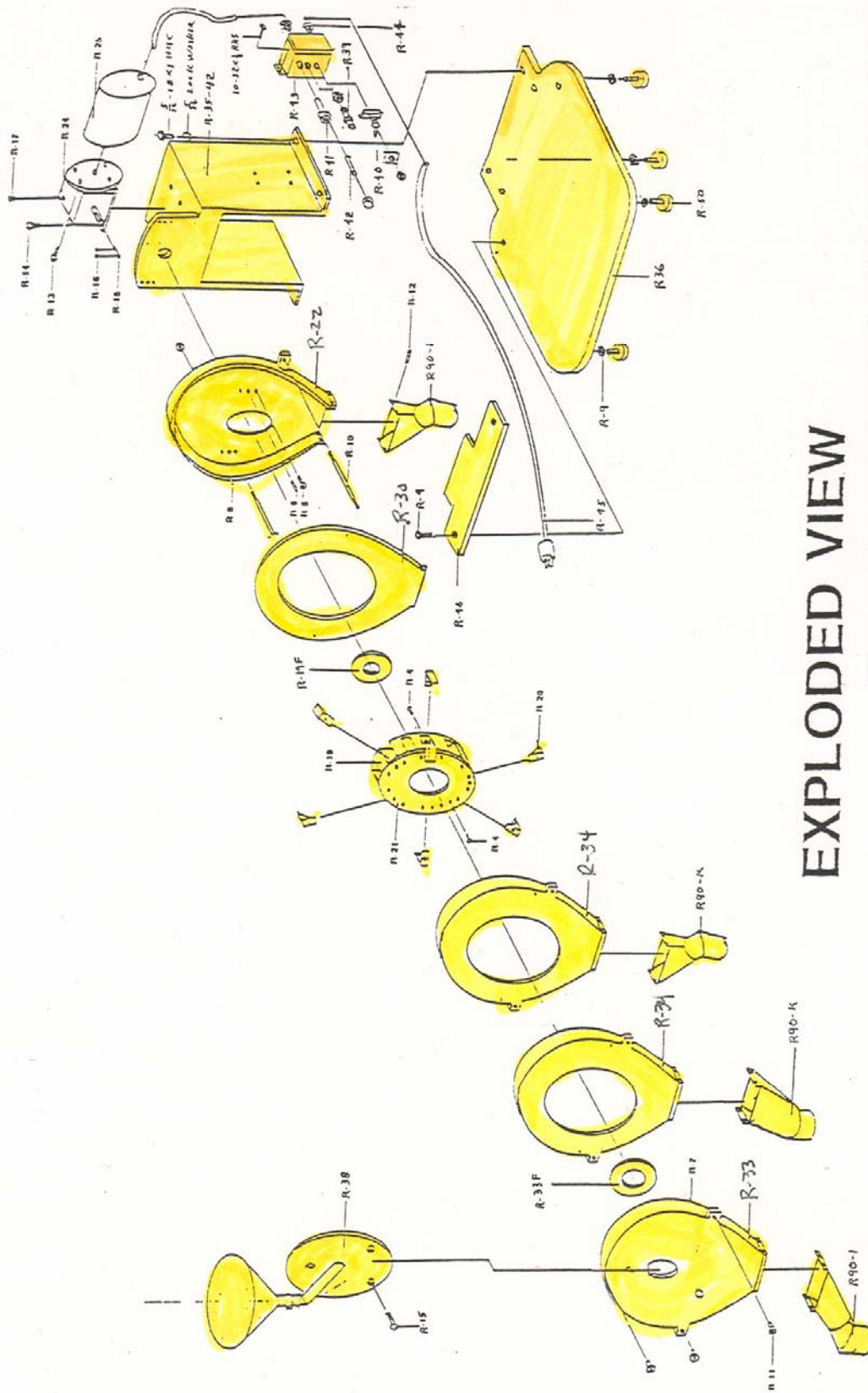

EXPLODED VIEW

4204 4 Way Divider

PRINT NUMBER :

TOLERANCE
UNLESS NOTED
0.000 ± 0.005
0.00 ± 0.010
0.0 ± 0.030
0 ± 0.050
ANGLE ± 2°

ENG. BY DATE

DRAWN BY DATE

KJ 3/23/00

CHK'D BY DATE

SCALE:

GAMET MANUFACTURING COMPANY
1211 PIERCE BUTLER ROUTE
ST. PAUL, MINNESOTA 55104



THIS DRAWING AND THE DESIGN AND ALL INFORMATION HEREON ARE THE PROPERTY OF THE GAMET MANUFACTURING COMPANY. IT IS TO BE KEPT IN STRICTLY CONFIDENTIAL AND NOT TO BE REPRODUCED OR COPIED IN ANY MANNER WITHOUT THE WRITTEN CONSENT OF THE GAMET MANUFACTURING COMPANY. THE DRAWING MUST NOT BE REPRODUCED AND MUST BE RETURNED TO THE GAMET MANUFACTURING COMPANY UPON REQUEST.

PARTS LIST

Series 4204 Rotary Divider

Give Divider Serial Number and Rotor Divisions When Ordering Parts.

PART NUMBER	DESCRIPTION
ASSEMBLY	
R19A-4240	Rotor Assembly
R22-42	Rear Housing
R24*	Reducer
R25*	Motor
R30-42	Housing Separator Plate
R31-42	Inlet Spout
R32-42	Inlet Spout and Attaching Flange Assembly
R33-42	Front Housing
R34-42	Center Housing (2ea.)
R35-42	Frame
R36-42	Base
R38-4200	Inlet Hopper Assembly
R43-ASSM	Control Assembly
R90-I	Front & Rear Spout (2 ea.)
R90-K	Center Spout (1ea.)

* **Bold denotes recommended spare parts**

REPLACEMENT PARTS

The following are the consumable / replaceable components in the system.

1 ea. Electric motor

1 ea. Gear reducer

1 ea. R19A Rotor assembly

4 ea. Plastic collection bins

2 ea. Fuse MDL8

CLEANING / MAINTENANCE

The following items should be maintained periodically.

- 1) Check gear reducer oil, change per manufacturer specifications.
- 2) Remove front cover and inspect rotor for wear.

TROUBLE SHOOTING

Problem

Possible Cause

System will not turn on

- *Circuit breaker from main power supply may be off
- *Fuse may be blown
- *System may not be plugged in

System does not divide accurately

- *Rotor is worn beyond tolerances