

# CA-700

## User Manual

**COFFEE LABORATORY**

**ANALYTICAL EQUIPMENT**  
[www.coffeelabequipment.com](http://www.coffeelabequipment.com)



### Operation Instruction

1

- Press on the power button to power on
- Insert the test chip to the Test-Chip slot

2

- Prepare the coffee for measurement

3

- Run the Coffee Analyzer app on your smart phone
- Click "START" on the app

4

- Use quantitative dropper for sampling coffee
- Put the coffee sample to the reagent for chemical mixture
- \*\*Use Pipette dropper for higher accurate result

### Product Introduction

The CA-700 portable Coffee Caffeine / Chlorogenic Acid (CGA) Analyzer is an accurate instrument for measuring the caffeine and CGA of coffee with its advanced mobility, accuracy, easy-to-operate feature, you can get the Caffeine and CGA value displayed on your smart phone app within 1 minute.

### Package Contents

- CA-700 x1
- 5V Power Adapter x 1
- USB type C charging cable
- Test Chip package x 10
  - Test Chip x 1
  - Reagent x 1
  - Dropper x 1 (for mixing reagent)
  - Quantitative dropper x 1 (for coffee)
- User Manual with Limited Warranty Page x 1

### Major Features

- One-click quick measurement
- Premix reagent
- Result in 1 minute
- Bluetooth connection for iOS/Android app

### Specification

Reading Range	Caffeine 10 – 500 mg/dL
	CGA
Sampling Size	0.1ml
	Dropper tolerance * Pipette +/- 6% (25 degree C)
	Dropper tolerance * Dropper +/- 12% (25 degree C)
Working Hour	2 – 3 continuous working hour per full charge
Weight	370g
Operating temperature	15~35°C
Storage temperature	5~45°C
Dimension	L: 202mm
	W: 78mm
	H: 40mm
Power adapter	110-240V, 50/60Hz
Charging input	5V, 0.5A, USB Type C

### App installation

- iOS: Search "Coffee Analyzer" on App Store
- Android: Search "Coffee Analyzer" on Google Play



Coffee Analyzer

### Classification of hazardous info.



WARNING

Substance: Coffee detection reaction solution

Hazardous ingredients: Sulfuric acid, oxalic acid, citric acid

Hazard warning message: Warning

Health hazard: Corrosive/irritating skin substances

**Hazard prevention:**  
Please operate the product in a well-ventilated place. It is strictly Forbidden from eating or drinking during the testing process, If the reagent contacts the eyes or skin, promptly wash (irrigate) the eyes with large amounts of water or seek medical attention as soon as possible.

**Manufacturer:**

- (1) Company : Lighttells Corp.. Ltd.
- (2) Address : 5F, No. 27, Xienzheng 3rd St., Zhubei city, Hsinchu county, Taiwan, R.O.C.
- (3) TEL : +886-3-555-1389

### CA-700 Hardware

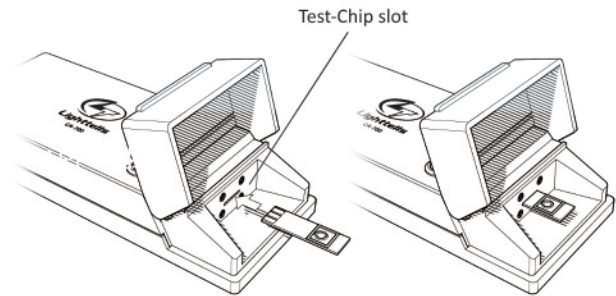
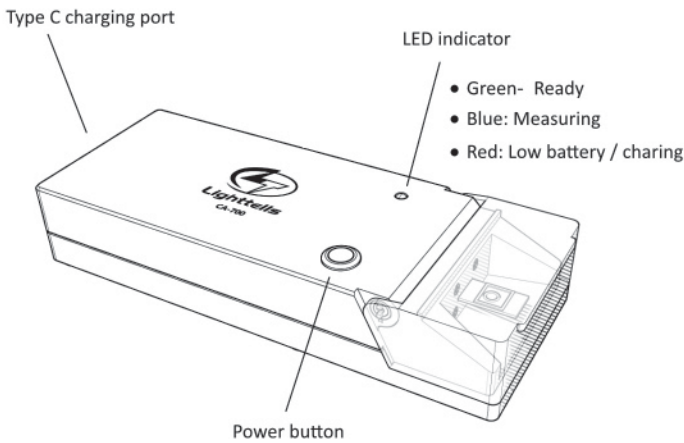

- Side up the test-chip, plug into the testing slot

### Package Contents

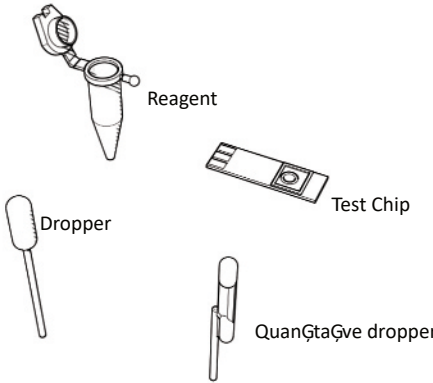

### Notice

- The testing pack is for Single-Use only, reuse IS NOT RECOMMENDED.
- For stable accurate result, it is not recommended charging while testing. Please stay the CA-700 on a stable plane.

### Limited Warranty Card

Model Name: CA-700 Coffee Caffeine Chlorogenic Acid Analyzer

Serial Number:

Date of Purchase: \_\_\_\_\_ YY  
\_\_\_\_\_ MM \_\_\_\_\_ DD

Customer Name:

Customer Address:

Authorized Dealer Name / Stamp:



Lighttells Corp. Ltd.  
<http://www.lighttells.com>